

# CONSTRUCTION NOTICE

## PILE DRIVING ACTIVITY

### WHAT

In the upcoming three to four months, the contractor will drive piles at different locations within the project limits (*see map below for pile driving locations*). The piles will provide the structural support necessary for the widening of Wilmington Ave. (between 220<sup>th</sup> St. and 223<sup>rd</sup> St.) and of I-405 (at the Dominguez Channel).

### WHERE

#### 1<sup>st</sup> Pile Driving Activity

■ Adjacent to Northbound I-405 at the Dominguez Channel

#### 2<sup>nd</sup> Pile Driving Activity

- Intersection of Wilmington Ave. & E. 223<sup>rd</sup> St.
  - Northeast corner - widening of Wilmington Ave.
  - Southwest corner - traffic signal installation.
  - Southeast corner - widening of Wilmington Ave.

### WHEN

#### 1<sup>st</sup> Pile Driving Activity

■ Monday, May 18 - Late June 2015

#### 2<sup>nd</sup> Pile Driving Activity

■ Tentatively, Late June – Mid-Aug. 2015

\* As the crews get closer to completing the first pile driving activity, more information about the 2nd pile driving activity will be available, including start date and possible street closures,.

### WORK HOURS

**Pile Driving Operations:** 7 a.m. to 5 p.m.

**Mobilization of Equipment:** 5 p.m. to 8 p.m.

*Note: Construction activity schedules and closures are subject to change due to inclement weather and/or other uncontrollable factors.*

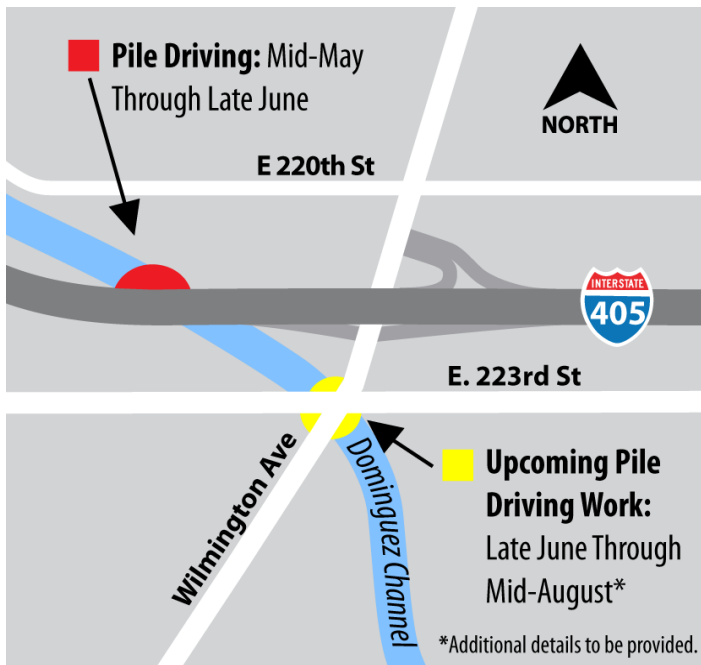

### WHAT TO EXPECT DURING ACTIVITIES

**Noise/Vibration:** You may experience noise and vibrations from the pile driving, back-up alarms, work crews and other construction related equipment and activities. As a precaution, we recommend that you secure any breakable items.

**Flagmen:** Flaggers will be onsite when necessary to allow access to traffic.

**Access:** Business and resident access will be maintained at all times.

**Dust Mitigation:** Water trucks will be used to minimize dust.

**Use caution when driving through construction zones.**

**FUNDING**



Metro



U.S. Department of Transportation  
Federal Highway Administration



Wilmington Ave

**KNOW BEFORE YOU GO**

**Toll-Free Hotline**  
**(877) 481-0004**

Visit the Website  
[I405Wilmington.com](http://I405Wilmington.com)  
to Sign Up for  
Email Updates

BILINGUAL STAFF IS AVAILABLE TO ANSWER YOUR QUESTIONS. \*EXCLUDING HOLIDAYS