

CONSTRUCTION NOTICE TRAFFIC SWITCH

WILMINGTON AVENUE - TEMPORARY FULL STREET & RAMPS CLOSURES

WHAT As a part of the project improvements, the crews will be conducting a traffic switch on Wilmington Avenue from the west side of the street to the east side. This will allow for the crews to continue with the widening of Wilmington Avenue on the west side of the street (traffic will be able to travel on the newly widen road on the east side of the street, adjacent to the gas stations). **This activity will require a temporary full street weekend closure of Wilmington Avenue between 220th Street and slightly south of 223rd Street as well as the closures of southbound and northbound I-405 on- and off-ramps, at Wilmington Avenue** (please see detour map below for closure and detour information). Thru traffic on 223rd Street will be allowed.

WHEN/WORK HOURS

- **Weekend Closure:** Friday, July 28 - Sunday, July 30, 2017 • 9 p.m. to 6 a.m.* (Continuous day & night work)*
- **Traffic Switch:** Friday, July 28 - late 2017

WHERE

Temporary full weekend closures:

- On Wilmington Avenue between 220th Street and slightly south of 223rd Street
- Northbound and southbound I-405 on- and off-ramps at Wilmington Avenue

* Construction activity schedules and closures are subject to change due to inclement weather and/or other uncontrollable factors. For schedule updates, please visit the project website, listed at the bottom of this notice.

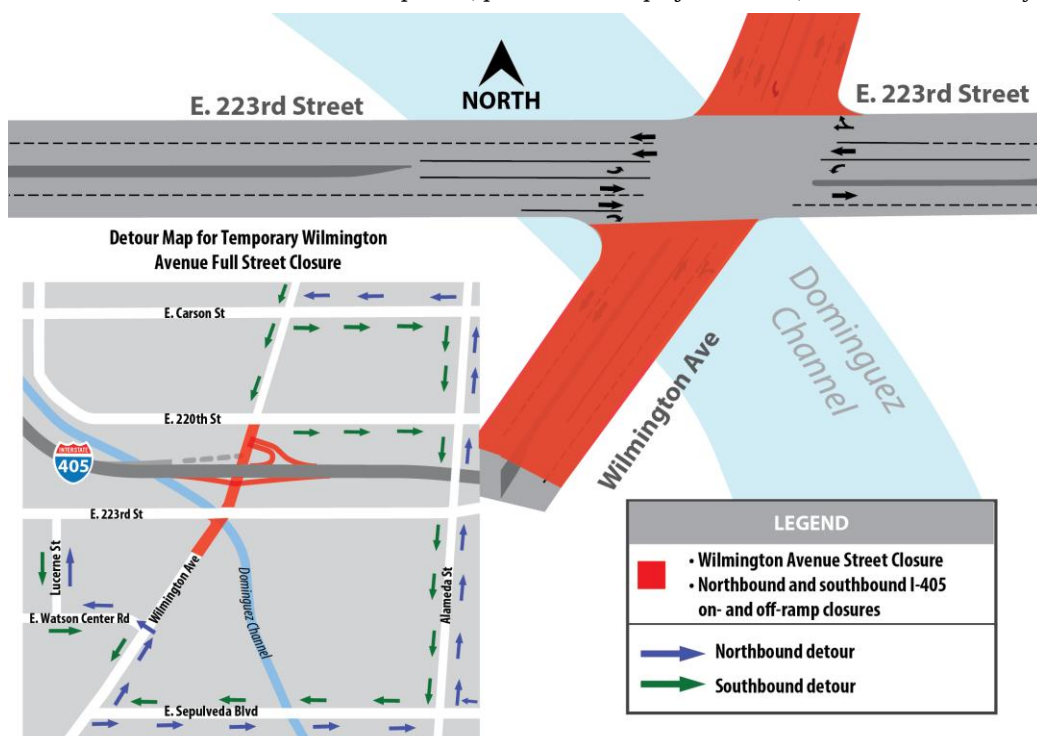

WHAT TO EXPECT DURING ACTIVITIES

Noise/Vibrations: You may experience vibrations and noise from back-up alarms, work crews and other construction related equipment and activities.

Flagmen: Flaggers will be onsite when necessary to allow access to traffic.

Access: Business and local resident access will be maintained at all times.

Dust Mitigation: Water trucks will be used to minimize dust.

Lighting: Extra lighting will be used for the night work.

FUNDING



Metro



U.S. Department of Transportation
Federal Highway Administration

Use caution when driving through construction zones.



Wilmington Ave

KNOW BEFORE YOU GO

Toll-Free Hotline
(877) 481-0004

BILINGUAL STAFF IS AVAILABLE TO ANSWER YOUR QUESTIONS. *EXCLUDING HOLIDAYS

Visit the Website
1405Wilmington.com
to Sign Up for Email Updates