

CONSTRUCTION NOTICE

PAVEMENT REPLACEMENT AT 223RD STREET & WILMINGTON AVENUE

WHAT As a part of the project's final stage improvements, the crews are continuing with final paving operations. The contractor, OHL, will implement final paving operations at the intersection of 223rd Street and Wilmington Avenue. This activity will require the **partial closure of 223rd Street with one lane open in each direction**. Southbound Wilmington Avenue will remain open but **northbound Wilmington Avenue will be temporarily closed**. There will be **no left turns** available onto Wilmington Avenue from eastbound and westbound 223rd Street. **Access to local residents and businesses will be maintained**. Please see below for additional schedule, closure and detour information.

WHEN/WORK HOURS

Friday, January 5 – Sunday, January 7, 2018 • 9 p.m. to 6 a.m. *(Continuous day & night work and partial closure)*

WHERE

Paving activity: intersection of 223rd Street and Wilmington Avenue

Partial closure: Westbound and eastbound 223rd Street (between Del Taco & east of Carson Toyota)

Full closure: Northbound Wilmington Avenue

* Construction activity schedules and closures are subject to change due to inclement weather and/or other uncontrollable factors. For schedule updates, please visit the project website, listed at the bottom of this notice.

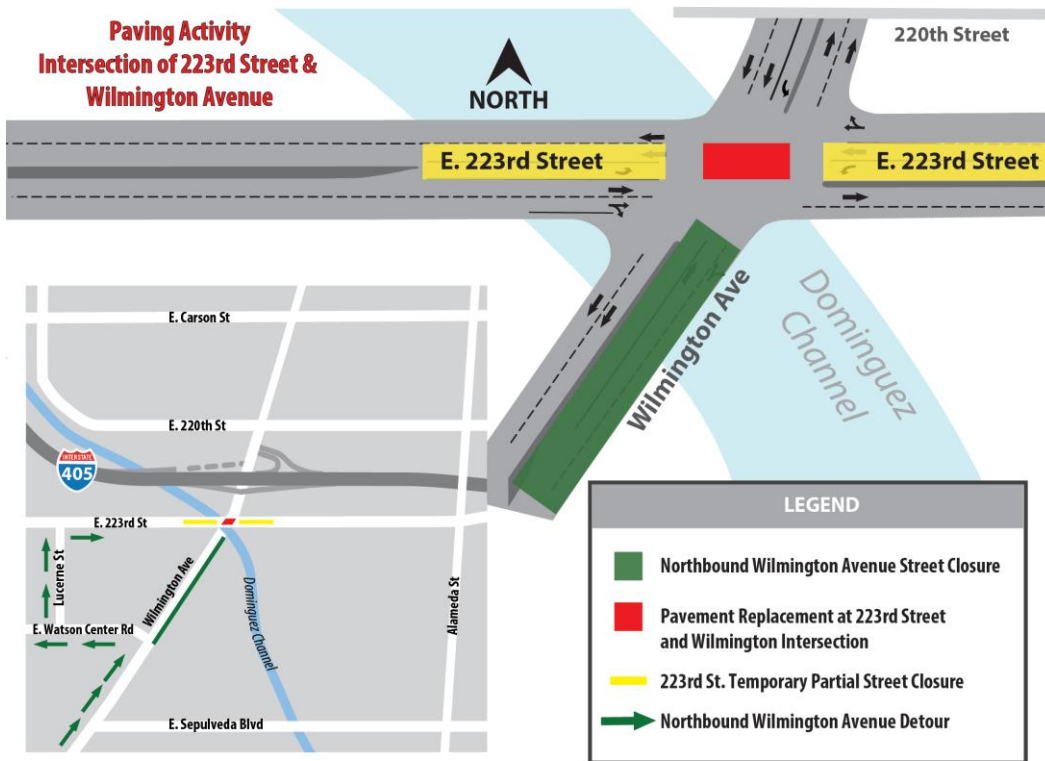

WHAT TO EXPECT DURING ACTIVITIES

Noise/Vibrations: You may experience vibrations and noise from back-up alarms, work crews and other construction related equipment and activities.

Flagmen: Flaggers will be onsite when necessary to allow access to traffic.

Access: Business and local resident access will be maintained at all times.

Dust Mitigation: Water trucks will be used to minimize dust.

Lighting: Extra lighting will be used for the night work.

FUNDING



Use caution when driving through construction zones.



Wilmington Ave

KNOW BEFORE YOU GO

**Toll-Free Hotline
(877) 481-0004**

Visit the Website
1405Wilmington.com
to Sign Up for
Email Updates

BILINGUAL STAFF IS AVAILABLE TO ANSWER YOUR QUESTIONS. *EXCLUDING HOLIDAYS